

Breathe Easy with Safari Snorkels

[Snorkel Models](#)

[Contact](#)

[Home](#)



Safari Snorkel - SS650HF

The Safari SS650-HF snorkel is tough and stylish and has been designed to deliver a huge volume of the coolest and cleanest air possible into the standard air cleaner assembly of the Mitsubishi Triton.

Right from the start, Safari took the decision to design a snorkel system that exceeded the air flow requirements of the gutsy 2.8L turbo diesel - and through thorough engineering and exhaustive testing of the SS650-HF snorkel system, those lofty design targets were achieved.



Close attention to the internal cross sectional profile and area, air velocity and flow path through each and every point along the entire length of the snorkel system ensures that the greatest air flow is achieved.

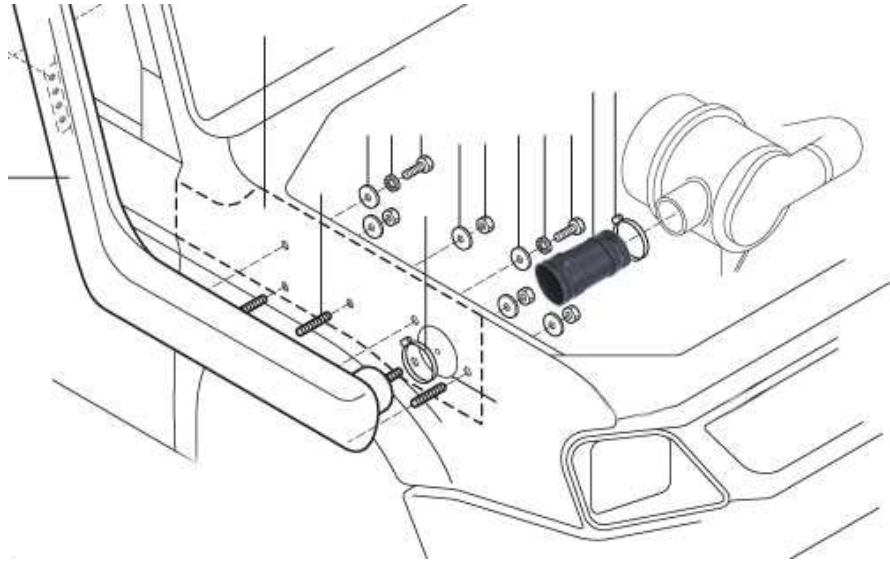

For example in order to achieve the optimum air flow and the maximum user convenience (for other under-hood accessories), a special **cuffed hose** was engineered to closely couple the snorkel body to the standard air intake assembly. This **specialized hose is specifically constructed for positive sealing** at each end **via sturdy cuffs** and is exceptionally tough to eliminate any possibility of hose collapse under suction - and super tough to withstand high under-hood temperatures. In addition, this special hose delivers a straight-shot of cool fresh air directly into the air cleaner assembly. The result is maximum engine performance and bullet-proof durability.



In other words, maximum engine performance and the best possible fuel economy, but also the best structural integrity for a lifetime of hassle-free motoring over and through the world's toughest terrain. A bonus is that the use of this special hose delivers the maximum convenience for those who wish to install additional under-hood accessories.



Huge air flow is but one aspect of the ultimate in snorkel design. The Safari air ram is designed to perform two very important roles. The most obvious is to funnel cool clean air into the snorkel body - but just as importantly, the Safari air ram acts as a highly efficient water separator to remove rain water from the incoming air stream - thus ensuring safe engine operation through even the most torrential

tropical storms.

In addition, the detachable Safari air ram can be rotated to any position. This means great peace of mind for those who plan to travel in cold or

high altitude conditions where heavy snow falls are anticipated. By rotating the air ram to face away from the prevailing wind/direction of motion, the air ram delivers additional protection from the choking effects of snow build-up inside the air intake.

The Safari Snorkel body is manufactured to the highest standards in durable, UV stable, cross linked polyethylene material. In addition, the substantial material wall thickness delivers huge physical strength to ensure that the snorkel breezes through the toughest off-road conditions on the planet.



The Safari Snorkel system is supplied as a complete and comprehensive system that includes every nut, bolt and bracket required for installation - right from robust zero-corrosion stainless steel studs, self-locking nyloc nuts and large diameter anodized body washers through to the tough plastic A-pillar inserts.

Breathe Easy - The genuine Safari Snorkel is positively sealed and delivers a continuous and cooler supply of air for the best engine protection on the planet.

