

## ATV & Side X Side Winches: ProVantage 2500



### ProVantage 2500

#### The ATV enthusiast's choice for smaller powersports vehicles

With 1134 kg of pulling capacity, this workhorse is equipped with premium components, and is ideal for recovering stuck ATVs on the trail or pulling heavy loads on the worksite. With an easy-to-use clutch dial, powerful permanent magnet motor, and all-metal gear housing, this winch is a market leader.

- 15m x 5mm wire rope and plow roller fairlead
- Hook, tie rods, and body feature attractive, durable, corrosion-resistant black finish
- Three-stage planetary gear train for smooth, efficient operation
- Ergonomic clutch handle
- Patented roller disc brake for outstanding control while winching
- Fully sealed to keep the elements out
- Plow roller fairlead
- Mini rocker control switch
- Wireless remote
- CE Compliant

SPECS/PART NUMBERS
Winch model: WARN ProVantage 2500
Part numbers: 91025
Rated line pull: 2500 lbs. (1134 kg)
Motor: 12V Permanent Magnet
Sealing: Full
Geartrain: 3-Stage Planetary
Rope Material: Wire
Rope length & diameter: 50' x 3/16" (15m x 5mm)
Primary Control: Handlebar Mini-Rocker
Remote Control: Wireless
Best for plow lifting: Yes
Brake: Patented Roller Disc
Certifications: CE Compliant
Mechanical Warranty: 3 Year
Electrical Warranty: 3 Year

PERFORMANCE DATA			PULL BY LAYER
Line Pull Lbs.(Kgs.)	Line Speed FT./min(M/min.)	Motor Current	Pull by layer layer/Lbs(Kgs.)
0	18.7 (5.7)	16.8	1/2500 (1134)
500 (227)	14.3 (4.4)	43.4	2/2125 (964)
1000 (454)	11.5 (3.5)	68.8	3/1806 (819)
1500 (680)	9.0 (2.7)	93.9	4/1535 (696)
2000 (907)	6.9 (2.1)	121.0	
2500 (1134)	5.4 (1.6)	152.4	

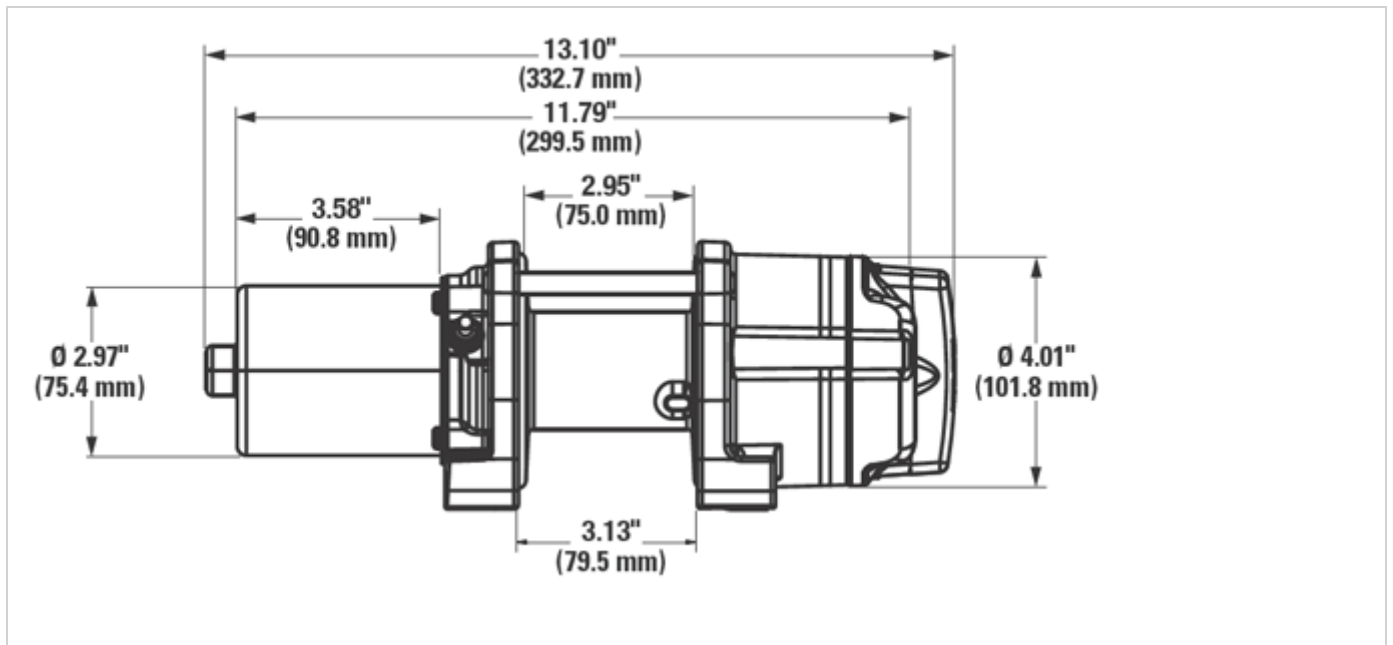

**Winch Dimensions:** 13.1" L. x 4.53" D. x 4.69" H. (333mm L. x 115mm D. x 119mm H.)

**Mounting Bolt Pattern:** 3.0" x 4.87" (76mm x 124mm)